

OUTLINE DIMENSION

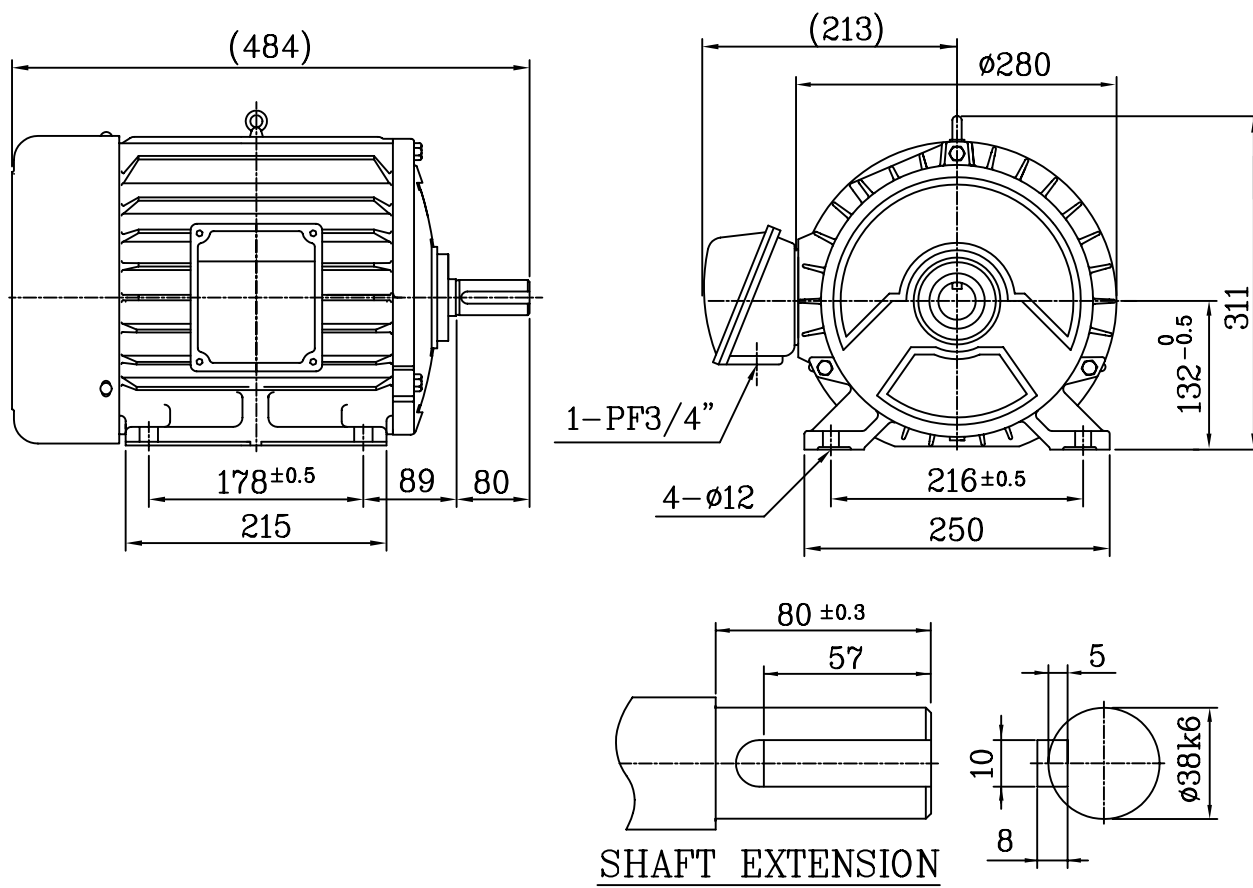

<NOTE>

1. TYPE : TEFC(Totally Enclosed Fan Cooled)

FOOTLESS MOUNTED TYPE

2. THE TOLERANCE FOR THE KEY DIMENSIONS

IS IN ACCORDANCE WITH KS B 1311-84

3. THE TERMINAL BOX MAY BE ROTATED

STEPS OF 90°

4. CAST IRON FRAME AND END BRACKETS.

5. STAINLESS STEEL NAME PLATE WITH CONNECTION DIAGRAM.

6. STEEL FAN COVER AND CAST TERMINAL BOX.

FRAME NO.	OUTPUT (kW)	POLE (P)	Hz	VOLTS (V)	INS. CLASS	PROTEC.	BEARING NO.	
							DRIVE	OPP.D.
132M	3.0	8	60	220/380	F	IP55	6208ZZ	6206ZZ

UNIT	mm	SCALE	$\frac{N}{S}$	PROJECT'N	3rd Angle	TITLE	OUTLINE
DESIGNED		CHECKED		APPROVED			
2009.03.19 A.R.LEE		2009.03.19 H.J.KIM		2009.03.17 H.J.KIM		SUBJECT	132M, B3
HIGEN Motor co., Ltd.						DWG. NO.	DW-I04HK9GH55